

THIS COPY HAS BEEN MADE BY OR WITH THE AUTHORITY OF EYEDALE DISTRICT COUNCIL, PURSUANT TO SECTION 47 OF THE COPYRIGHT DESIGNS AND PATENTS ACT 1988. UNLESS THAT ACT PROVIDES A RELEVANT EXCEPTION TO COPYRIGHT, THE COPY MUST NOT BE COPIED WITHOUT THE PRIOR PERMISSION OF THE COPYRIGHT OWNER.

Date Valid 08/11/2018

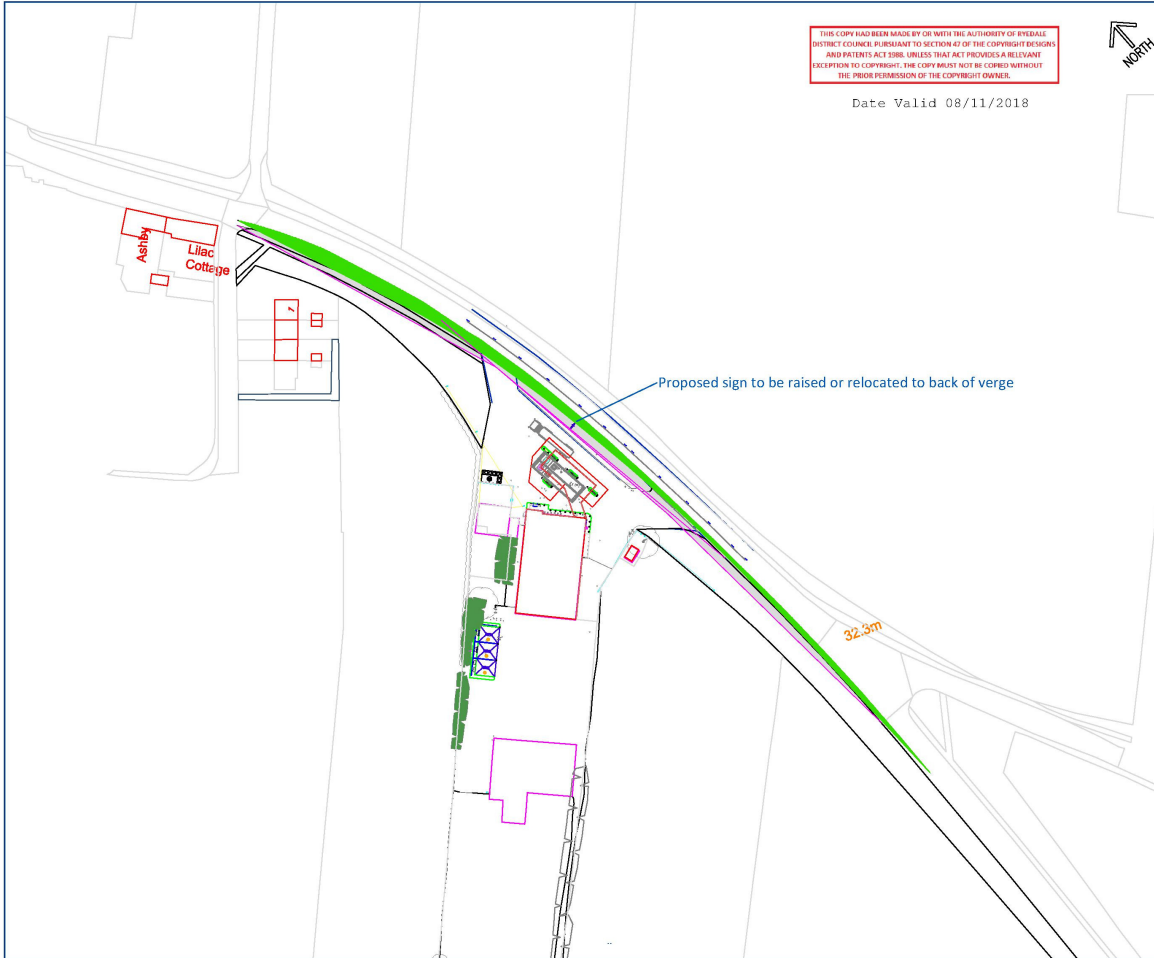

1:500m  
© Local Transport Projects A3

**Key:-**

	Visibility Splay of 2.4m x 80m
	Visibility Splay area to be retained as public highway
	20m Forward Visibility Splay (20m) to be retained. Minimum of 2.0m retained. 2.0m kept from kerb line

**Disclaimers:-**

- i. This drawing is copyright and must not be copied in part or in whole unless agreed in writing by Local Transport Projects Ltd.
- ii. Reference should be made to the project's drawing register to ensure the latest drawing is being referred to.
- iii. All dimensions are to be checked by the contractor prior to commencing work. Any discrepancy shall be reported immediately to Local Transport Projects Ltd.
- iv. All work shall be carried out in accordance with local authority, statutory authority and health & safety requirements & regulations.
- v. Based on topographic survey supplied by ADS Design and Ordnance Survey (OS) mapping, Crown Copyright 2018.

Rev.	Date	By	Chk	Description
B	08/11	JH	AM	Final sign and fence details (2018)
A	08/11	JH	AM	Final sign based on 2018

Client  
**Jos Richardson & Son**

Project  
**Middleton Service Station,  
Keld Head, Pickering**

Title  
**Access Visibility Splays**

**local transport projects**  
traffic engineering and transport planning

Armeding House,  
The Arming Way,  
Armeding Way,  
Barnsley, S70 2JH  
Tel: 01226 811111  
www.localtransportprojects.co.uk

Drawn	JH	Date	03/10/2018
Scale	1 : 1000	Checked	AM
Status	<input type="checkbox"/> INTERNAL DRAFT <input checked="" type="checkbox"/> PRELIMINARY <input type="checkbox"/> ISSUE <input type="checkbox"/> CONSTRUCTION <input type="checkbox"/> APPROVED <input type="checkbox"/> AS BUILT		
Drawing number	LTP/3436/P1/01	Issue	01
Project	Middleton Service Station	Client	Jos Richardson & Son